

Supplementary instructions for the Version 1.1 updates

Standard Accessories

- ① Instruction book
- ② Power supply cable
- ③ USB cable
- ④ Hoop M1 (MB Hoop 240 X 200)
- ⑤ Hoop M2 (MB Hoop 126 X 110)
- ⑥ Hoop M3 (MB Hoop 50 X 50)
- ⑦ Hoop supporter
- ⑧ Felt ring (large)
- ⑨ Felt ring (small)
- ⑩ Spool rest (shape changed)
- ⑪ Thread guide bar
- ⑫ Spool pin
- ⑬ Thread guide pole
- ⑭ Spool stand
- ⑮ Setscrew (C)
- ⑯ Setscrew (A)
- ⑰ Setscrew (B)

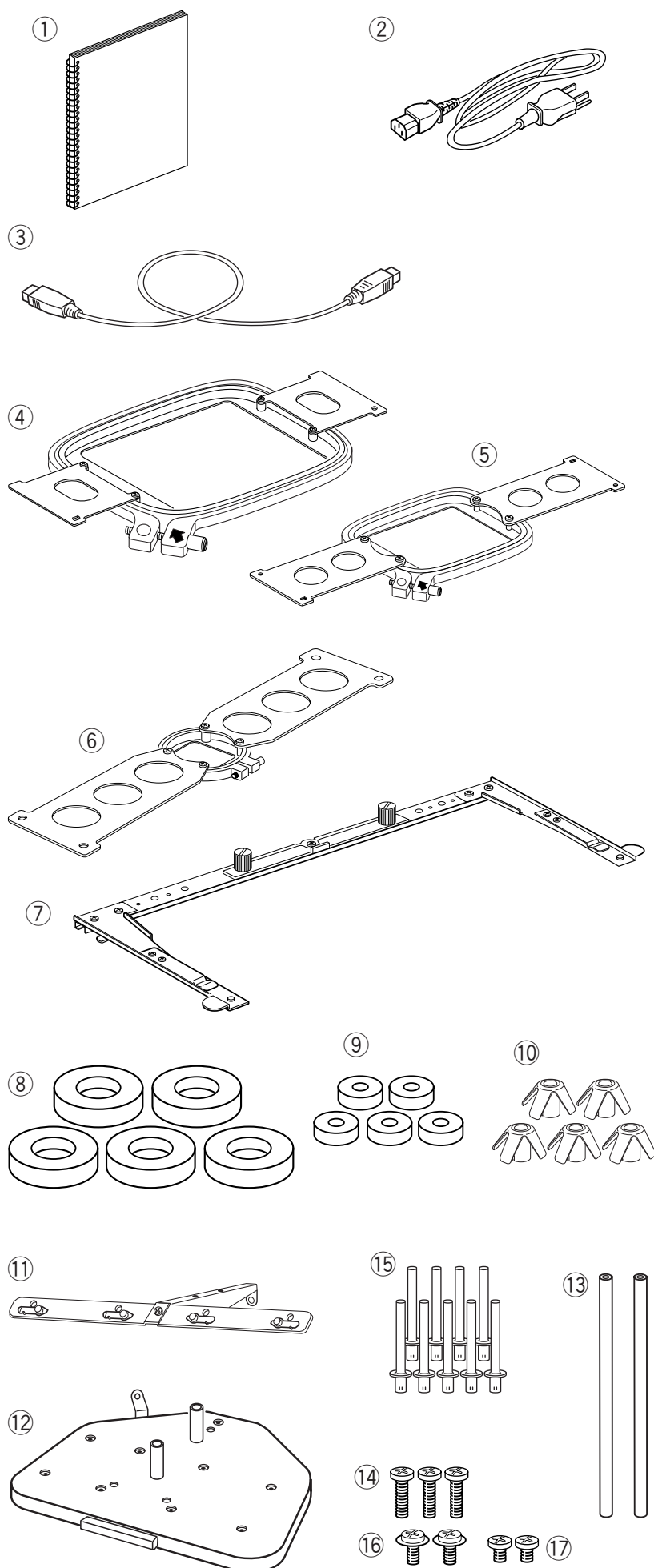

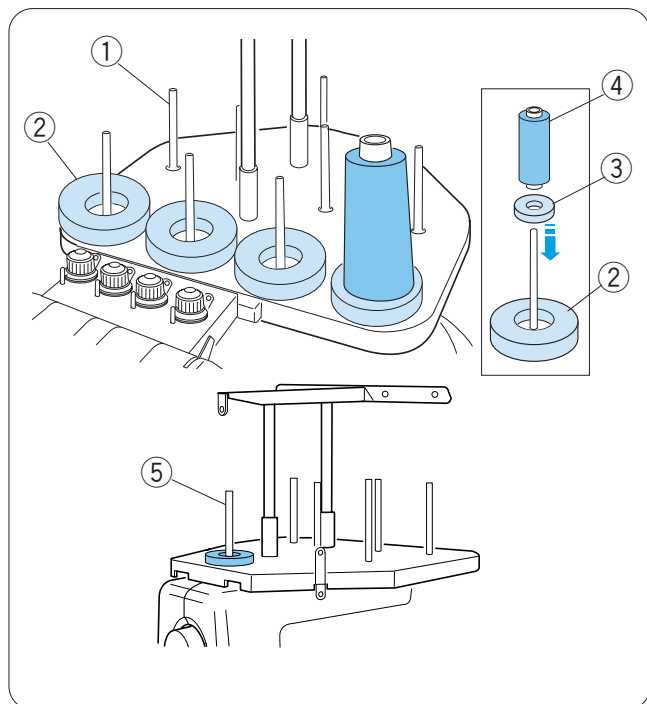

Setting the Thread Cones or Spools of Thread

Use the 4 spool pins in the front row for sewing, and second row spool pins are for the standby spools. Use the rear most spool pin for bobbin winding.

Felt rings of two sizes are provided to accommodate various types of spools of thread and thread cones. Use the large felt rings for large thread cones. For small thread cones or spools of thread, insert the small felt rings into the large rings.

- ① Spool pin
- ② Felt ring (large)
- ③ Felt ring (small)
- ④ Small spool of thread
- ⑤ Spool pin for bobbin winding

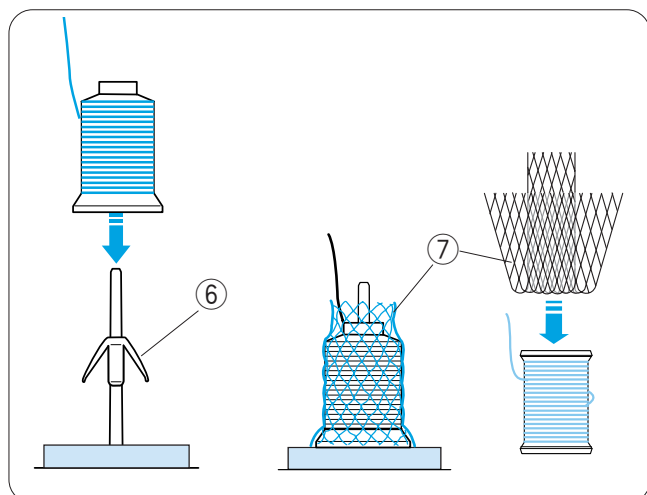

Setting the thread cone

Attach the spool rests on the spool pins. Place the thread cones on the spool pins.

Cover the thread cone with the spool net if the thread is shaky or kinky when sewing. If the net is too long for a spool, fold the net and place it on the spool.

- ⑥ Spool rest (shape changed)
- ⑦ Spool net

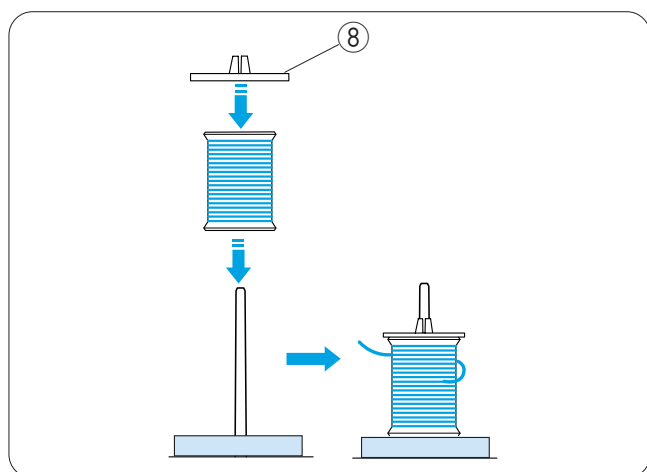

Setting the spool of thread

Place the spool of thread on the spool pin, with the thread coming out from the left backside. Attach the spool cap and firmly press it against the spool.

- ⑧ Spool cap

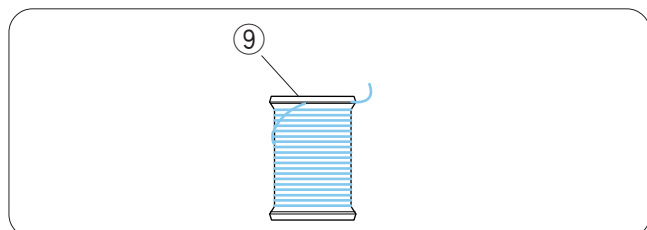

NOTE:

To prevent the thread from unraveling, leave the net on the thread cone or hook the thread end into the notch of the spool when it is not in use.

- ⑨ Notch

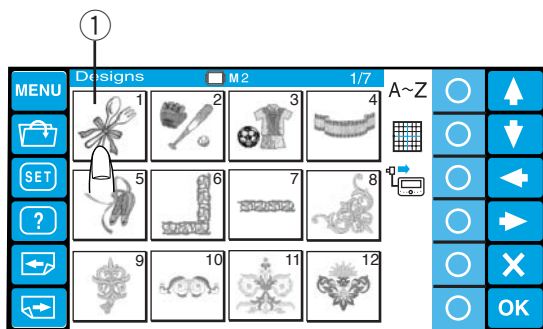

Press the pattern selection key and the Ready to sew window will open.

- ① Pattern selection key

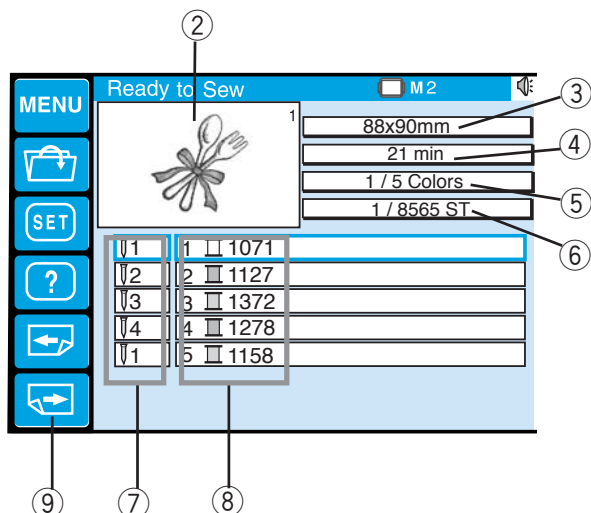

The stitch image of the selected pattern and a list of the thread color assignment to each needle bar along with the sewing information are displayed on the screen.

- ② Stitch image
- ③ Design size
- ④ Sewing time in minutes
- ⑤ Total thread colors required
- ⑥ Total stitch count
- ⑦ Needle bar number
- ⑧ Assigned thread color to the needle bar

Press the next page key to show the remaining colors of the list.

- ⑨ Next page key

Function keys (circle keys)

Color list option

Press the circle key next to the color list icon to switch display between 4 colors and 8 colors.

- ① Circle key (color list option)

Press the circle key next to the color section icon to show the complete stitch image or the selected color section only

- ② Circle key (color section)

Color section (layer) setting

You can select the color section from where you wish to start sewing.

Press the circle key next to the next section (a spool with "+" icon) to select the next section.

- ③ Circle key (next section)

Press the circle key next to the previous section (a spool with "-" icon) to select the previous section.

- ④ Circle key (previous section)

The selected color section will be indicated with a red frame.

Automatic color assignment

If you open a Tajima embroidery file (*.DST), which does not have color information, you need to assign the colors to all the sections.

To assign the colors automatically, press the circle key next to the auto color assignment icon.

- ⑤ Circle key (auto color assignment)

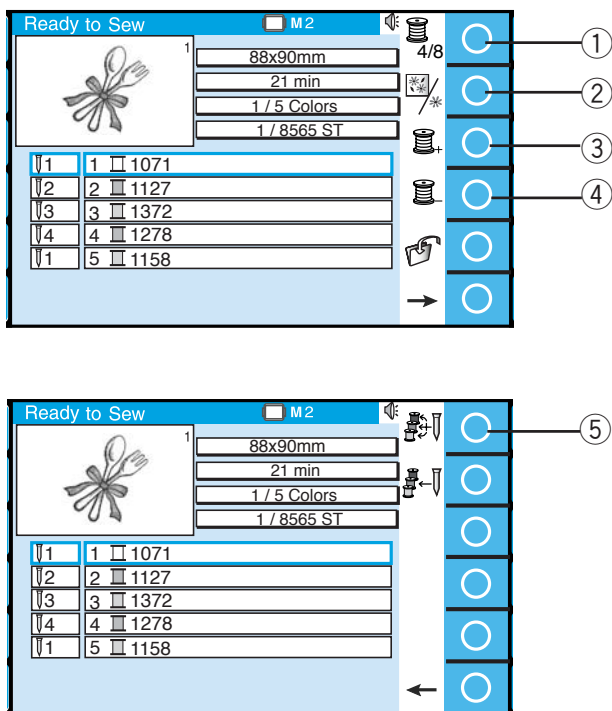

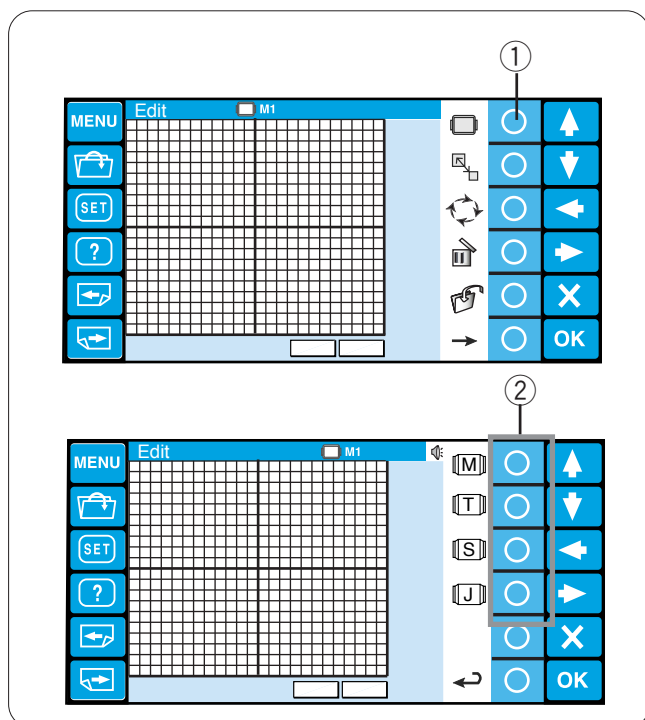

Editing Functions

Selecting the hoop

Press the circle key next to the hoop icon.

① Circle key (hoop)

The function key assignment will change to the hoop type selection.

The following hoop types are available:

- [M] : MB hoops
- [T] : Tajima hoops (optional item)
- [S] : Socks and Hat hoops (optional item)
- [J] : Monogram hoops (optional item)

Press the circle key next to the icon of the desired hoop type.

② Circle key (hoop type)

Then select the desired hoop by pressing the corresponding function key.

The editing screen will change to the selected hoop size.

The following hoops can be selected:

Standard hoops

- M1: MB Hoop 240 x 200
- M2: MB Hoop 126 x 110
- M3: MB Hoop 50 x 50



CAUTION:

Select the appropriate hoop for the size and purpose of embroidery pattern.

Using a wrong hoop may result it hitting the foot.

Optional Tajima hoops

- T1: Tajima hoop 24 x 24 mm (933100239A00*)
- T2: Tajima hoop 38 x 38 mm (933100439A00*)
- T3: Tajima hoop 59 x 59 mm (933100639A00*)
- T4: Tajima hoop 79 x 79 mm (933100839A00*)
- T5: Tajima hoop 100 x 100 mm (933101039A00*)
- T6: Tajima hoop 39 x 160 mm (933200239A00*)

(*Tajima part number)

Optional special hoops

- S1: Socks hoop 37 x 59 mm
- S2: Socks hoop 28 x 50 mm
- H1: Flat hat hoop 100 x 90 mm

Optional monogram hoops (hoop adapter required)

- J1: No. 11 Monogram hoop 30 mm dia.
- J1: No. 12 Monogram hoop 30 mm dia.
- J2: No. 6 Monogram hoop 24 x 54 mm
- J3: No. 13 Monogram hoop 64 x 28 mm
- J4: No. 8 Monogram hoop 42 x 67 mm
- J5: No. 3 Monogram hoop 46 x 46 mm
- J6: No. 9 Monogram hoop 66 x 66 mm
- J7: No. 1 Monogram hoop 110 x 95 mm
- J8: No. 7 Monogram hoop 120 x 121 mm

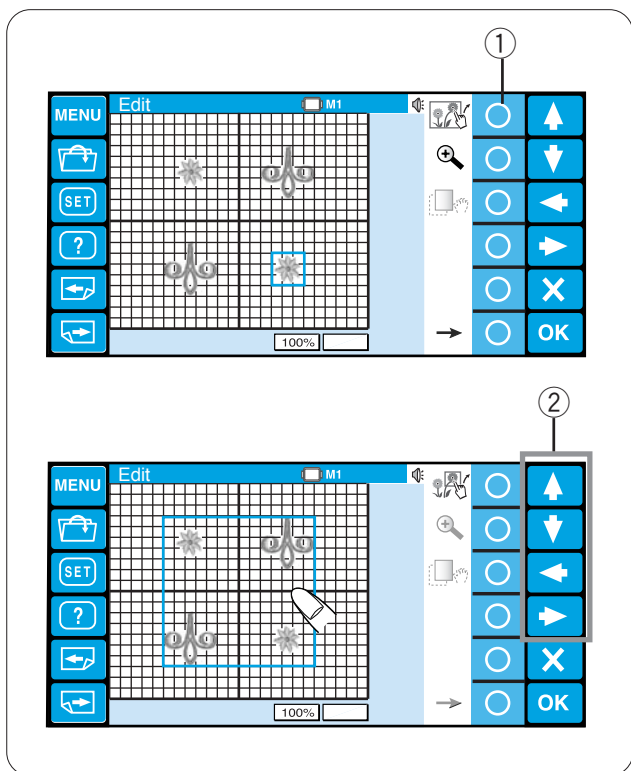

Grouping the patterns

You can move more than one pattern at one time by grouping the patterns.

Press the circle key next to the grouping icon.

- ① Circle key (grouping)

The patterns in the editing window will be combined as a single group.

Move the grouped patterns to the desired position with the arrow keys or by dragging with your finger tip.

- ② Arrow keys

To untie the patterns, press the circle key next to the grouping icon again.

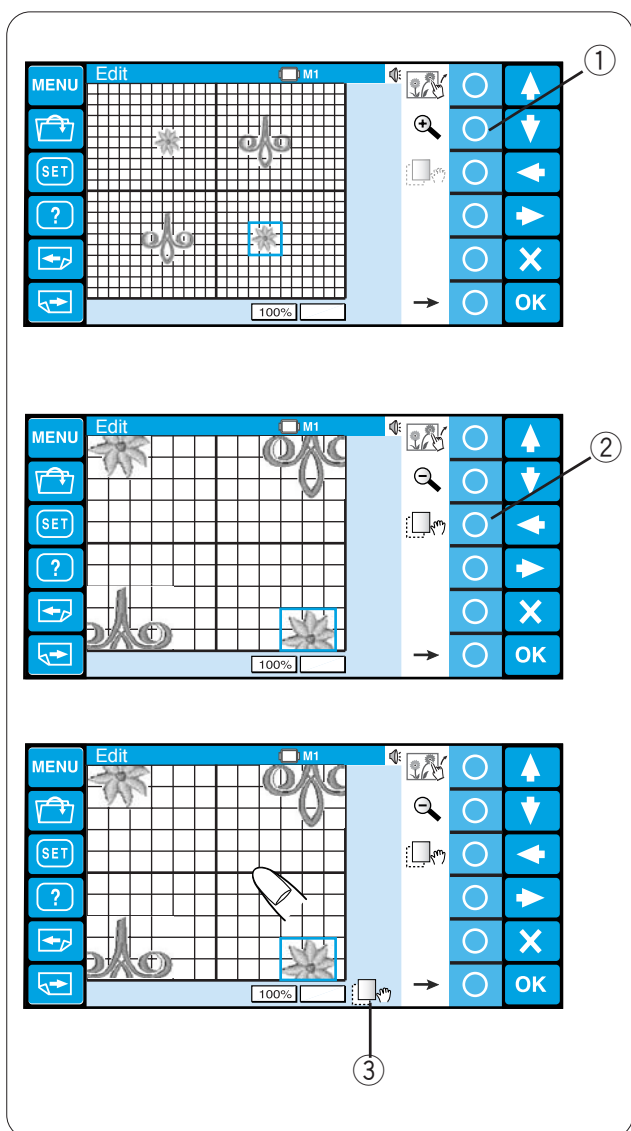

Zooming the editing window

Press the circle key next to the magnifier icon to zoom-in and zoom-out the editing window.

- ① Circle key (zoom)

To scroll the zoom-in window, press the circle key next to the scroll icon.

- ② Circle key (scroll)

The scroll icon on the bottom of the screen indicates that the window is in the scrolling mode.

- ③ Scroll icon

Drag the window to scroll in the desired direction.

Press the circle key next to the scroll icon again to exit the scrolling mode.

NOTE:

The pattern cannot be moved in the scrolling mode.

4

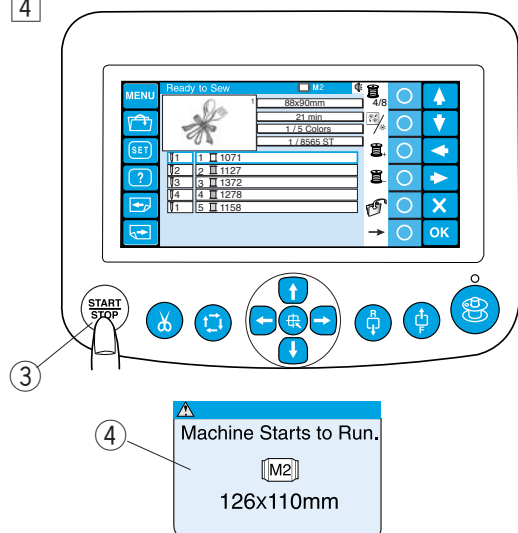

5

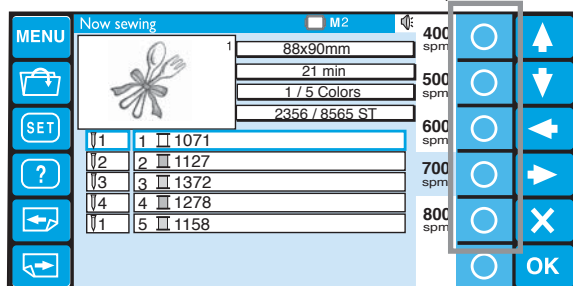
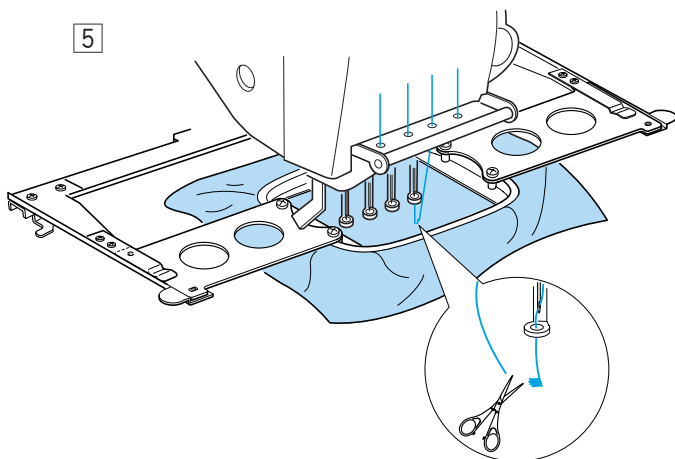

- 4 Press the START/STOP button, the LCD screen will show the reminder asking you to confirm the hoop type to be used.

- ③ START/STOP button
- ④ Reminder message

NOTE:

If you press the START/STOP button when the tension release lever is in the open position, a warning message will appear. Pull the tension release lever up to close the tension disk.

Check the hoop size and press the START/STOP button again to sew a few stitches.

- 5 Press the START/STOP button to stop the machine.

Trim the thread at the beginning.

Then, press the START/STOP button again. The machine will sew up to the fourth color and stop automatically.

Re-thread each needle with the next color and press the START/STOP button to continue sewing.

Refer to page 29 for how to remove the hoop.

You can change the sewing speed while stitching.

Press the circle key next to the desired speed.

- ⑤ Circle keys (sewing speed)

If the thread breaks or runs out while stitching, the machine will automatically stop and the hoop will go back to the position where the thread broke or ran out.

However, you can fine-tune the restarting position by moving the hoop.

Press the stitch forward button to move the hoop forward 10 stitches.

- ⑥ Stitch forward button

Press the stitch back button to move the hoop backward 10 stitches.

- ⑦ Stitch back button

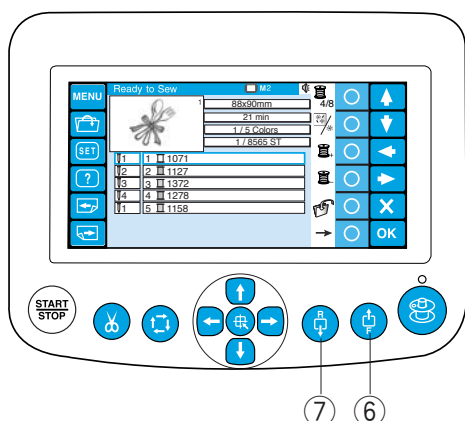

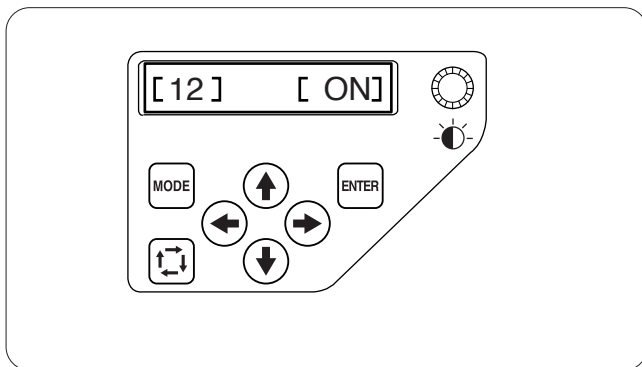

[12] Jump thread trimming ON/OFF

If you wish to trim jump threads automatically, press the right arrow button (→) to indicate **[ON]**. Press the left arrow button (←) to disable the jump thread trimming.

Press the ENTER button to register the new setting or press the upward arrow button (↑) to go to the next setting.

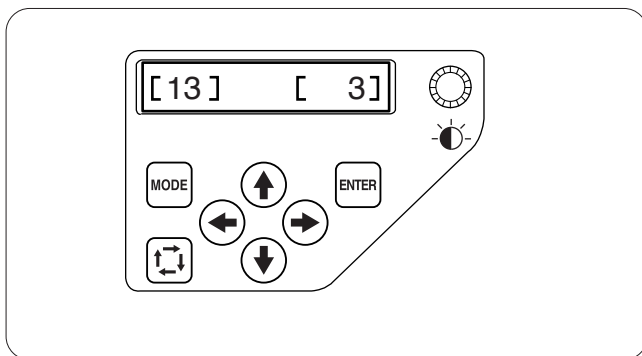

[13] Jump thread trimming threshold

You can adjust number of jumps, which triggers the jump thread trimming.

The machine will trim the jump thread automatically after the specified number of jumps.

Press the right or left arrow button (← →) to adjust the number of jumps.

The adjustable range is from 1 to 8.

The lower the number, the shorter the jump thread trimmed

Press the ENTER button to register the new setting or press the upward arrow button (↑) to go to the next setting.

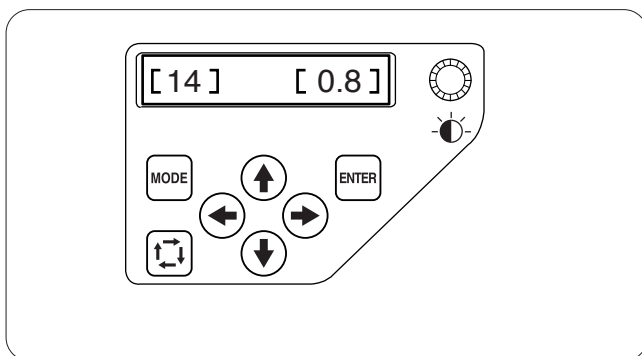

[14] Thread trimming position

If threads are not trimmed properly, adjust the needle drop position where the threads being trimmed.

Press the right or left arrow button (← →) to set a distance between the thread trimming position and the last stitch of the pattern section or select **[OFF]** to turn off the function.

The adjustable range is from 0.5 to 1.0.

Press the ENTER button to register the new setting or press the upward arrow button (↑) to go to the next setting.

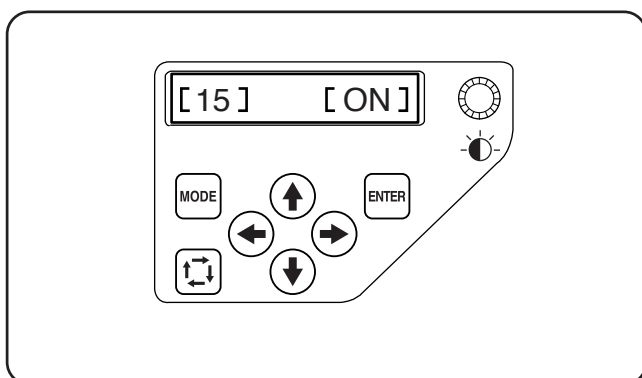

[15] Resume mode ON/OFF

When resume mode is enabled, the last stitch of the pattern sewn before turning the power off will be resumed when the power is turned on again.

Press the right or left arrow button (← →) to turn **[ON]** or **[OFF]** the resume mode.

When you turn the power on, the confirmation window will open.

Press the OK key to resume the last stitch of the pattern sewn.

Press the ENTER button to register the new setting or press the upward arrow button (↑) to go to the next setting.

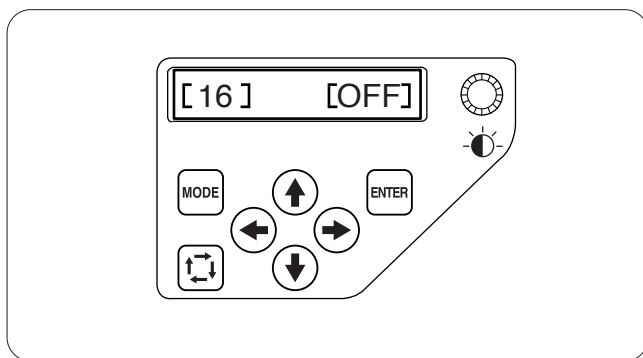

[16] Locking stitch ON/OFF (after color change)

The threads may ravel if the stitch data does not contain locking stitches at the beginning of each color section.

To avoid ravelling, insert locking stitches at the beginning by pressing the right arrow button (→) to indicate **[ON]**.

Press the left arrow button (←) to disable this function.

Press the ENTER button to register the new setting or press the upward arrow button (↑) to go to the next setting.

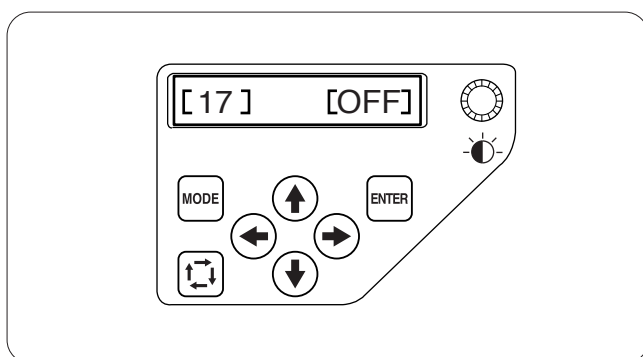

[17] Locking stitch ON/OFF (after thread trimming)

If you turn ON the jump thread trimming (refer to the previous page), insert locking stitches after the jump to avoid threads from ravelling.

Press the right arrow button (→) to indicate **[ON]**.

Press the left arrow button (←) to disable this function.

Press the ENTER button to register the new setting.

If you wish to cancel the changes, press the MODE button and LCD screen will return to the My setting mode display without registering the settings.

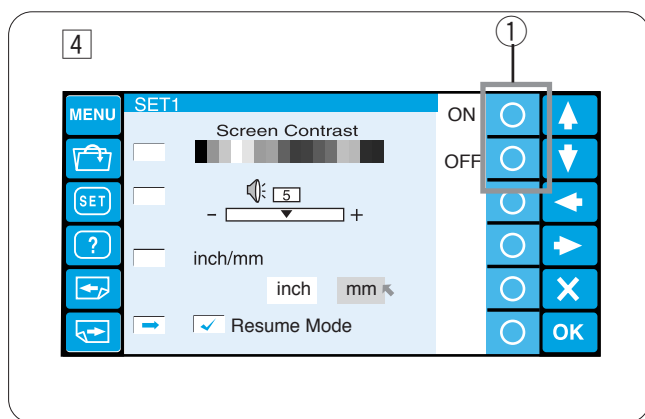

4 Resume mode ON/OFF

When resume mode is enabled, the last stitch of the pattern sewn before turning the power off will be resumed when the power is turned on again. Press the circle key next to “ON” or “OFF” to turn on or off the resume mode.

① Circle keys (ON, OFF)

When you turn the power on, the confirmation window will open.

Press the OK key to resume the last stitch of the pattern sewn.

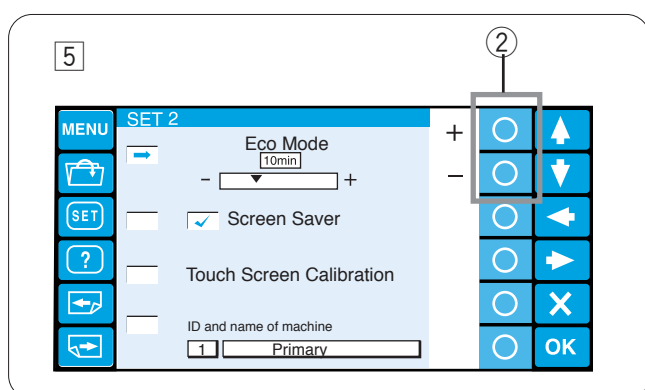

5 Eco mode setting

The sewing lights will turn off, and the LCD screen go dark if you have not used the machine for a while. Touching the screen will turn on the sewing lights and screen.

The Eco mode timer can be set from 1 to 30 minutes by pressing the circle key next to the “+” or “-” sign.

② Circle keys (+, -)

To turn off the Eco mode, press the circle key next to the “+” sign until “OFF” is displayed in the box.

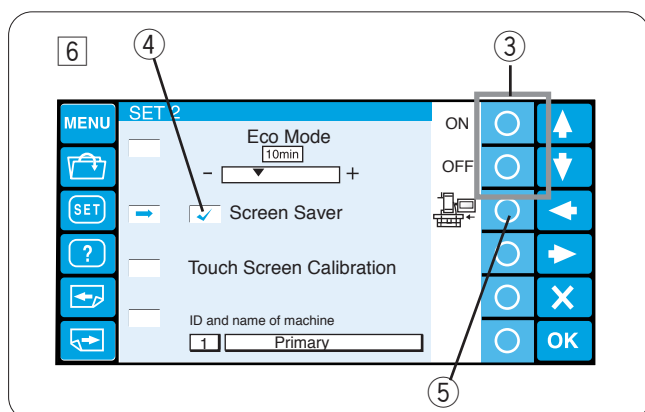

6 Screen saver

If the screen saver is activated, it will be shown on the LCD screen instead of entering the eco mode.

To activate the screen saver, press the circle key next to “ON”.

When it is activated, a check mark will appear in the box.

To inactivate the screen saver, press the circle key next to “OFF”.

③ Circle keys (ON, OFF)

④ Check mark

NOTE:

You can import the original screen saver via the ATA PC card or USB memory by pressing the circle key next to the machine icon.

⑤ Circle keys (machine)

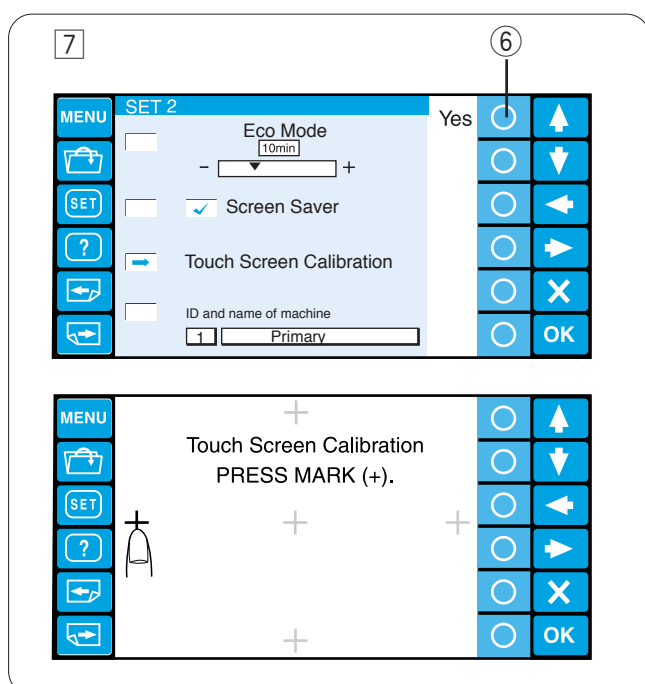

7 Touch screen calibration

If you feel the keys on the touch screen do not respond correctly, adjust the key position in this mode.

Press the circle key next to “Yes” and the touch screen calibration window will open.

Press the cross mark “+” with your fingertip in the order as they appear on the touch screen.

When you press the last cross mark, the finishing screen appears for a while and then the screen will return to the setting mode window.

⑥ Circle keys (Yes)

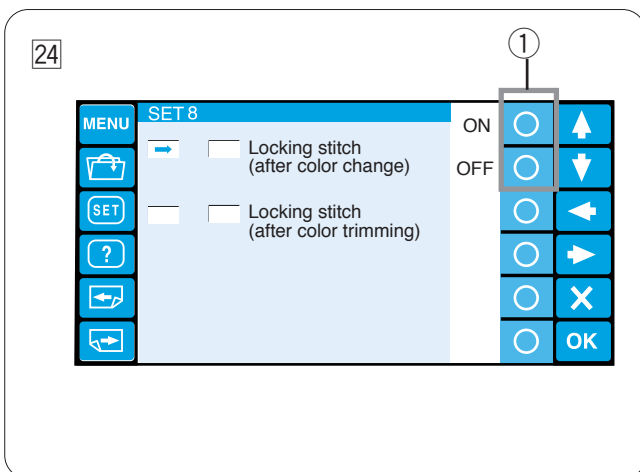

24 Locking stitch ON/OFF (after color change)

The threads may ravel if the stitch data does not contain locking stitches at the beginning of each color section.

To avoid ravelling, insert locking stitches at the beginning by pressing the circle key next to "ON".

Press the circle key next to "OFF" to disable this function.

① Circle keys (ON, OFF)

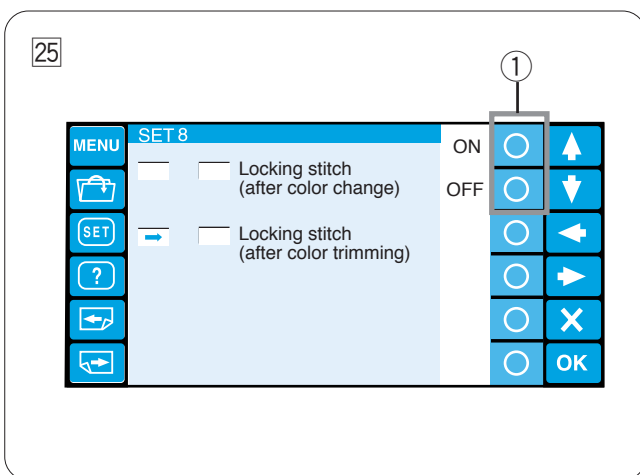

25 Locking stitch ON/OFF (after thread trimming)

If you turn ON the jump thread trimming (refer to the previous page), insert locking stitches after the jump to avoid threads from ravelling.

Press the circle key next to "ON" or "OFF" to turn on or off the function.

① Circle keys (ON, OFF)

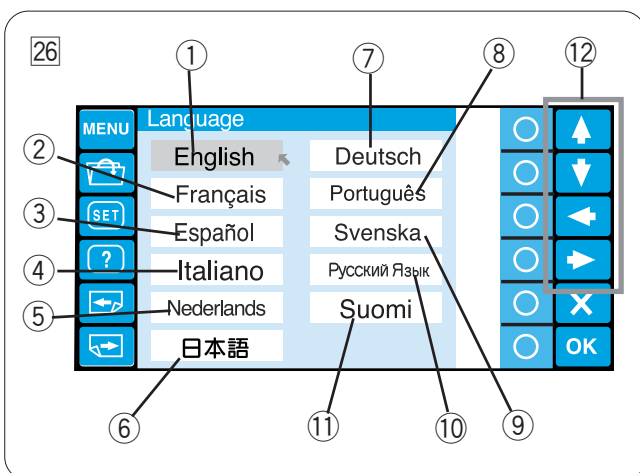

26 Language selection

You can select one of the following languages for screen message.

- ① English
- ② French
- ③ Spanish
- ④ Italian
- ⑤ Dutch
- ⑥ Japanese
- ⑦ German
- ⑧ Portuguese
- ⑨ Swedish
- ⑩ Russian
- ⑪ Finnish

Press the arrow key to move the cursor (red arrow) to the language you wish to select.

⑫ Arrow keys

Press the OK key to confirm your selection.

Or press the exit key to close the setting mode window and return to the previous window.

